

PTO
Perry*Lecompton Middle School
Perry, Kansas

To: Perry*Lecompton USD 343
Board of Education

From: Theresa Bowser, President

Subject: To request the Board of Education approve, fund and oversee the design, preparation, equipment acquisition and installation of a fenced and gated playground, football area and soccer area at the location West of the 5th-6th grade wing of the school.

WHY: The question was raised to the children, parents, teachers and administration: “What is good for our kids?” and “What do kids need?” and “Where does it fit in school plans?” and “Does it enhance the school program?”. The overwhelming recommendation is for a playground, more basketball surfaces with 2 new goals, some outdoor tables & seating, and fencing for safety. The Middle School is great, but it has to have better, bigger outdoor spaces for kids to play and congregate. It is a huge wellness element and would offer an appropriate transitional playspace for the 5th and 6th graders especially.

WHERE: The area is just West of the West end of the school. The area is in good proximity to the doors where kids exit the building. It is accessible to all students. It will have the football/track fence as its West boundary and with new pieces of fencing in this proposal will be a large protected space, easy for teachers to monitor & control. The basketball area would be added to the small concrete slab there now. The tables would be in the common outside area between the school wings, where tables are now.

WHEN: Now. If approved, the equipment could be ordered and on site in 4-5 weeks and the installation by the contractors would quickly follow. The site could be prepared, equipment set, concrete poured, fences installed, and the pea gravel spread out under the pieces yet this school year.

WHAT: Creation and installation of modern outdoor accommodations for play, exercise, congregating, socializing and especially health and wellness for our kids is our main objective. Answering the question of what best serves kids, in a big way, comes easily when considering and implementing a big, well thought out playground with a small group of missing amenities to complete the overall educational picture at our school.

WHO: The PLMS PTO Playground Committee will go to work for the Board of Education and staff to facilitate the creation of these areas. We have received excellent consultation & support from Cunningham Associates, Inc., from the professionals in their Blue Springs, MO office. They have the playground, basketball and seating products. They provide installation of all pieces. The concrete, pea gravel and fences will be

provided by local contractors and suppliers. The teachers, staff and lots of the kids have all signed up to be a part of the project in any way that they can.

As the questions were raised as to what is good for kids, the fence all the way around the space was number one, primarily from the child safety aspect. Another top of the list item is the basketball facilities and surfaces. The 2 goals are crowded with kids standing in line to play. They also, as a group, fill up just about all the remaining surface area just hanging out. It is especially over used on rain or snow days, which in turn limits ball playing. The picnic furniture pieces outside are also high on the list.

BUDGET: Our request is for \$67,624.00

It is broken down as follows:

Playground Equipment	\$30,324.00
Installation/Equipment	\$ 7,900.00
Pea Gravel/Delivered	\$ 9,800.00
Concrete Work	\$10,000.00
500 ft. of Fencing	\$ 9,600.00

In order of importance, we see the following as a possible phase-in schedule for the project:

1. Pour new basketball concrete flatwork at West end of PLMS, around existing areas.
2. Provide fence and gates around project area. Move soccer goals to the North end of this area.
3. Provide and spread pea gravel.
4. Buy and install part of playground equipment.
5. Buy and install balance of playground equipment.

We would appreciate your positive response to this proposal by approving it in full. Please see our site plan and color illustration, attached. We will have additional info, for your information at the November Board of Education meeting. Thank you for your consideration.

Sincerely,

Theresa Bowser
President, PLMS PTO

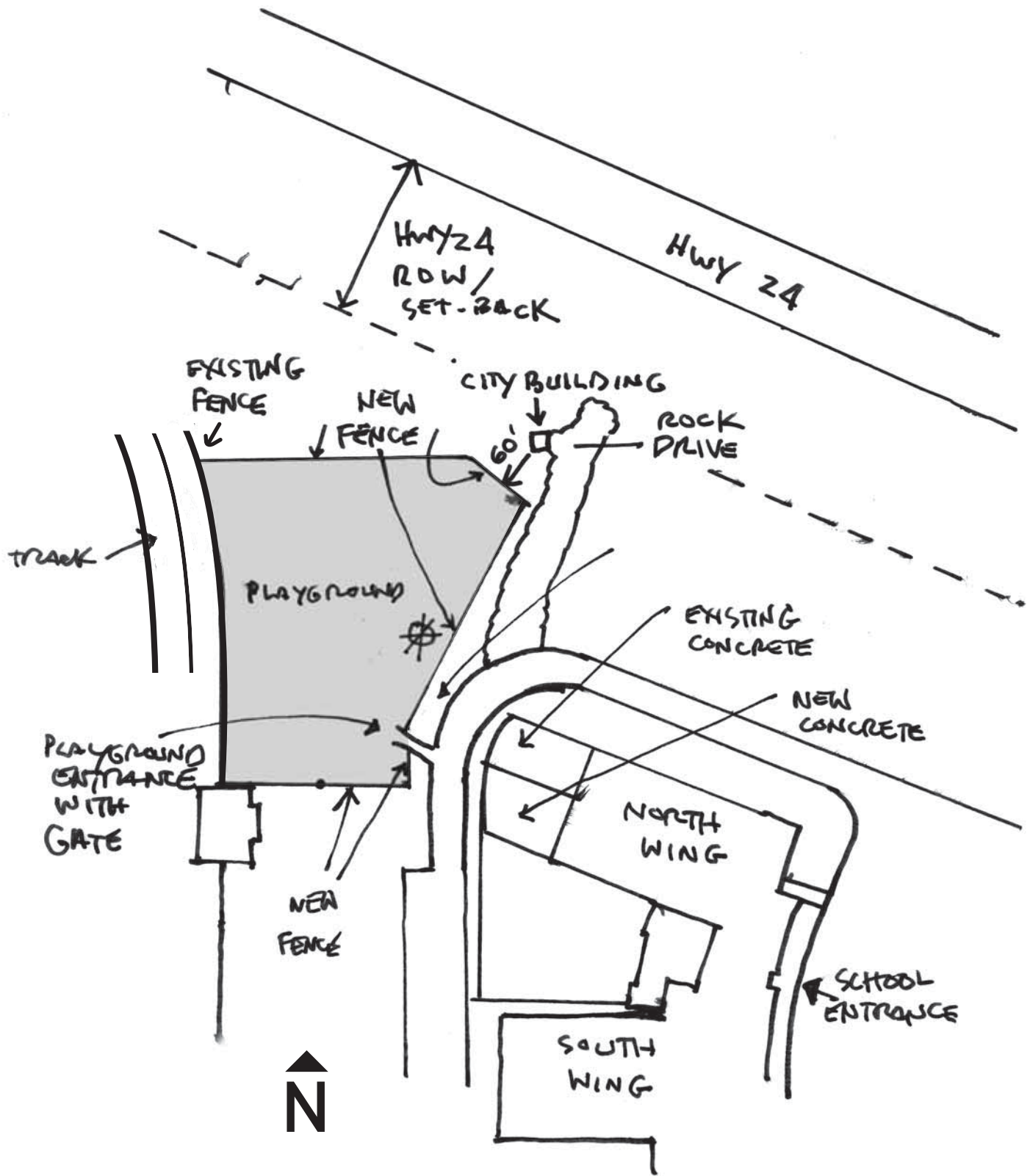

PERRY * LECOMPTON
 MIDDLE SCHOOL PLAYGROUND SITE PLAN

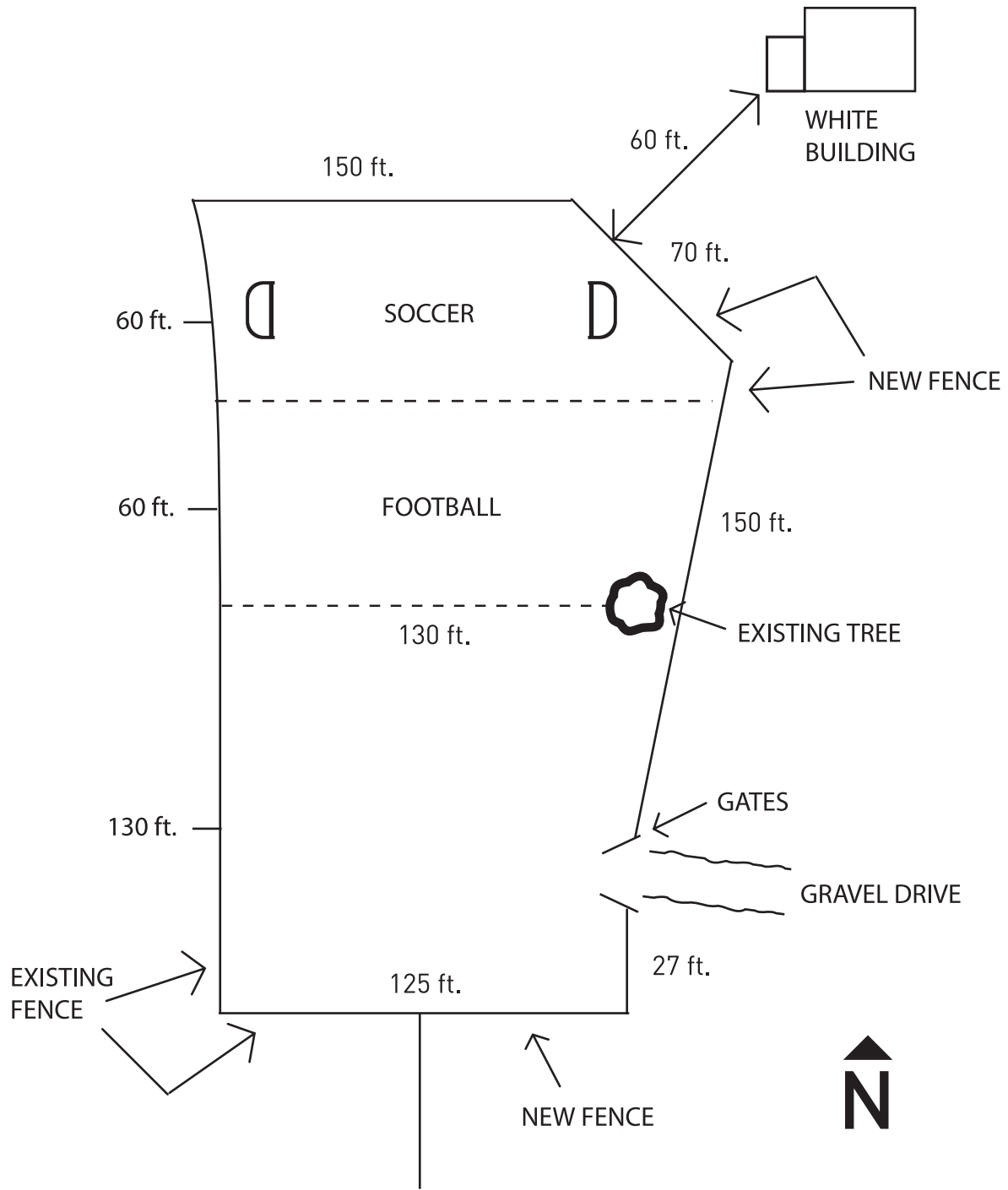

PERRY ★ LECOMPTON
MIDDLE SCHOOL PLAYGROUND SITE PLAN



Perry USD #343
 Perry Lecompton
 Parents Group -4
 Lecompton, KS

No.	Revision	Date

This play equipment is recommended for children ages 5 - 12 .

Soft, resilient surfacing should be placed in the use zones of all equipment, as specified for each type of equipment, and at depths to meet the critical fall heights as specified by the U.S. consumer Product Safety Commission, ASTM standard F 1487 and Canadian Standard CAN/CSA-Z-614.



Drawn By: **KMH** Scale:
 Date: **10-16-07**
 Drawing Name: **perry4 10-16-07**

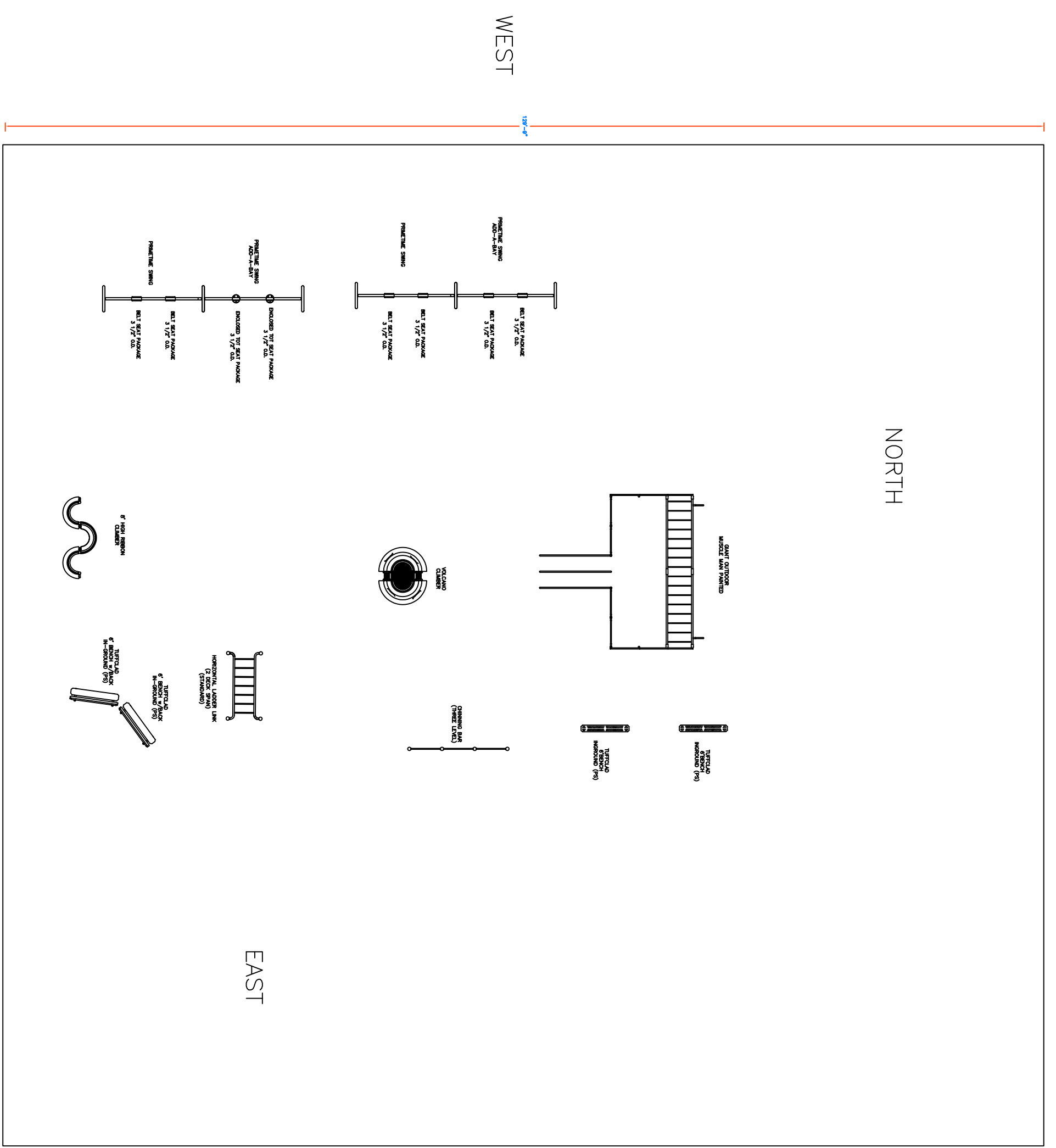

NORTH

WEST

EAST